

The Sylva Pattaya

Muang Pattaya, Thailand

Reference: 7245

฿39,900,000



4 Bedrooms



0 Bathrooms

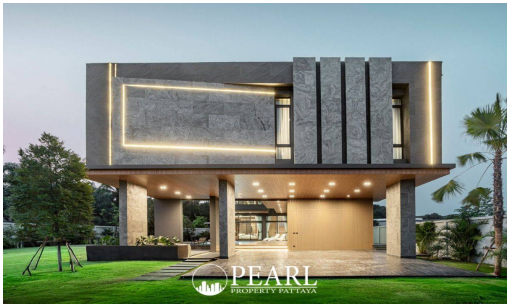

Villa

Property Description

Pearl Property presents The Sylva Pattaya - an exclusive sanctuary of eight luxury pool villas in tranquil Huai Yai.

Discover refined living at *The Sylva Pattaya*, a boutique collection of just **eight modern contemporary villas** set within the lush, peaceful surroundings of Huai Yai Road (Tetsaban Soi 27). Developed by **Arneja Estates Co., Ltd.**, this private gated community offers discerning buyers a rare blend of upscale design, privacy, and nature.

Each villa spans a generous **705 sqm usable area**, with land plots ranging from **555.88 to 658.68 sqm**. Thoughtfully designed over three levels, these 5+1 bedroom residences feature seven bathrooms, a maid’s room, and expansive indoor and outdoor living spaces ideal for family life and sophisticated entertaining.

Project Highlights:

- **Total Land Area:** 3-0-88 rai (approx. 5,152 sqm)
- **Number of Units:** 8 luxury pool villas
- **Architectural Style:** Modern contemporary

- **Expected Completion:** Q4 2026

Premium Villa Features:

- Double-volume living room
- European kitchen with island and separate spice kitchen
- Lounge bar, utility room, and storage space
- **Private saltwater infinity pool**
- Landscaped garden, terrace, and rooftop deck
- Covered parking for up to 3 cars

Community & Security:

- Gated estate with **24-hour security**
- **Smart home integration** for enhanced comfort
- CCTV surveillance throughout

Lifestyle & Location:

Located just minutes from Pattaya's top attractions, residents enjoy easy access to:

- Jomtien Beach
- Pattaya Floating Market
- Siam Country Club
- Nong Nooch Garden

- Ramayana Water Park
- French International School

Live where luxury meets serenity. **Contact us today to learn more about The Sylva Pattaya or to arrange a private viewing.**

Photo Gallery

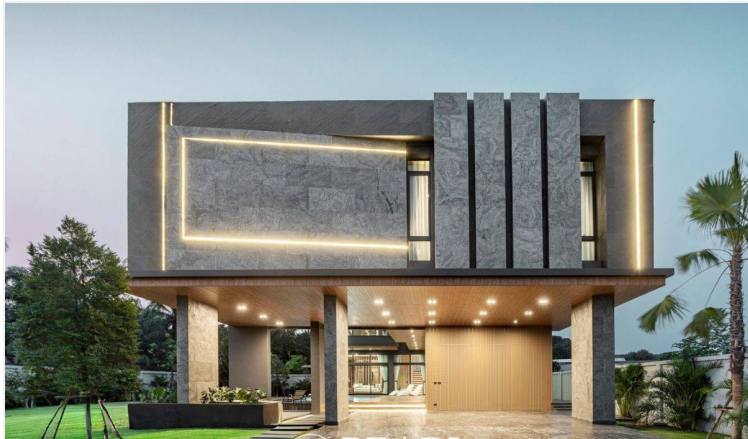

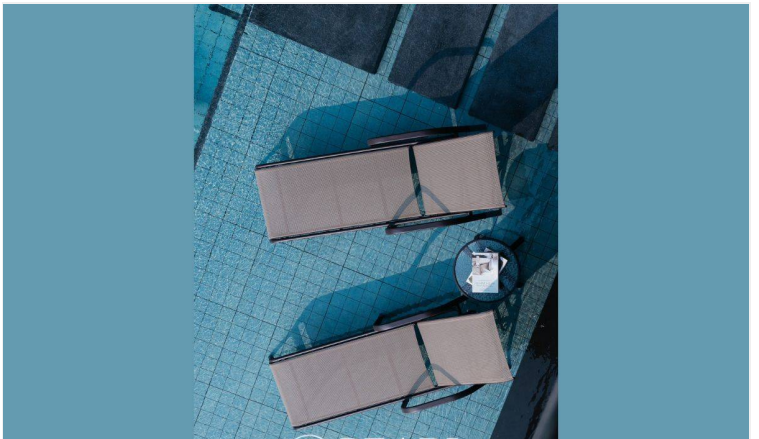
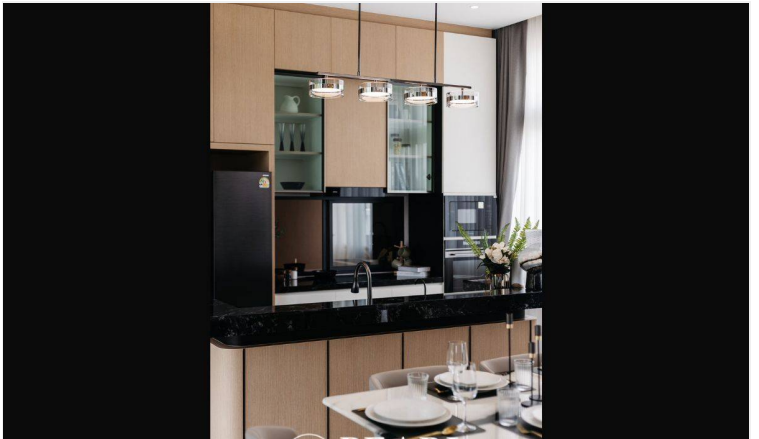



Property Details

- **Property Type:** Villa
- **Location:** Muang Pattaya, Thailand
- **Land Area:** 5152m²
- **Price:** ฿39,900,000
- **Bedrooms:** 4
- **Bathrooms:** 0

Property Features

- Security
- Jacuzzi
- Swimming Pool
- Air Conditioning
- Balcony
- Car Park
- Electricity
- Integral Kitchen
- Internet
- Alarm
- Guardhouse
- Lift
- Office
- Roof Garden
- Equipped Kitchen
- Terrace

Location

