

Majestic Residence - (3-storey) 4 Bed 5 Bath With Private Swimming Pool

Muang Pattaya, Thailand
Reference: 4823

฿69,000,000



4 Bedrooms



5 Bathrooms



Villa

Property Description

Majestic Residence, located in the serene Cosy Beach area on Soi Kasetsin, offers luxurious beachfront living with direct access to the beach. Just 10 minutes from Pattaya’s lively city center and close to popular dining spots like The Sky Gallery and The Chocolate Factory, it offers a perfect blend of tranquility and convenience.

The property is under construction, with completion scheduled for December 2025. The home features a spacious living area of 682 m² and sits on a 530.4 m² land plot, spread over 3 floors (2 above ground and 1 basement). It includes 4 bedrooms, 5 bathrooms

Exclusive features include a private infinity-edge pool with a swim jet, Jacuzzi, and starlights, a high-end cinema room, a spa area with a sauna, steam room, and fitness area, and an outdoor Sala perfect for relaxation and entertaining.

The home boasts superior construction with a reinforced concrete structure and waterproofed basement. The 30 cm thick exterior walls provide excellent insulation and durability, while the imported natural stone finishes add an elegant touch.

Smart living features include a full Philips Hue multi-color lighting system, high-quality double-insulated glass for noise and temperature control, centralized air-conditioning, and a full LAN/Wi-Fi/CCTV system. Additionally, the property is designed with sustainability in mind, offering efficient water management, an automatic garden sprinkler system, and eco-friendly design elements for long-term comfort and energy efficiency.

This exceptional property combines luxury, comfort, and advanced technology for an unparalleled living experience.

Photo Gallery

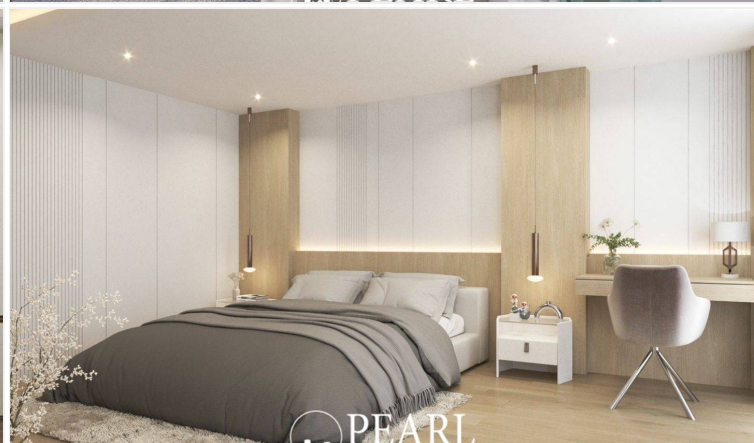
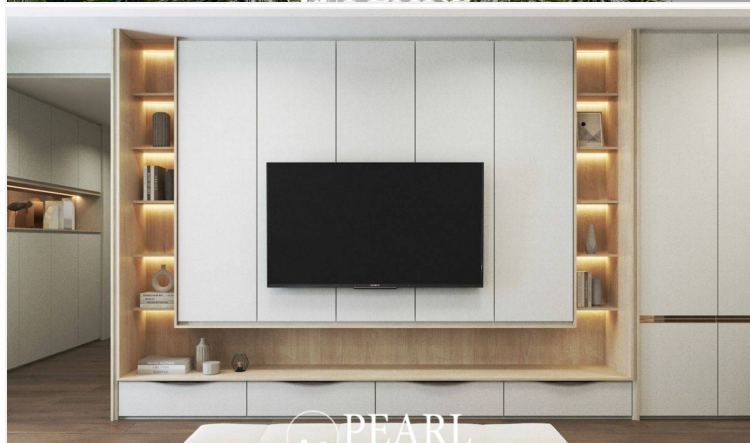
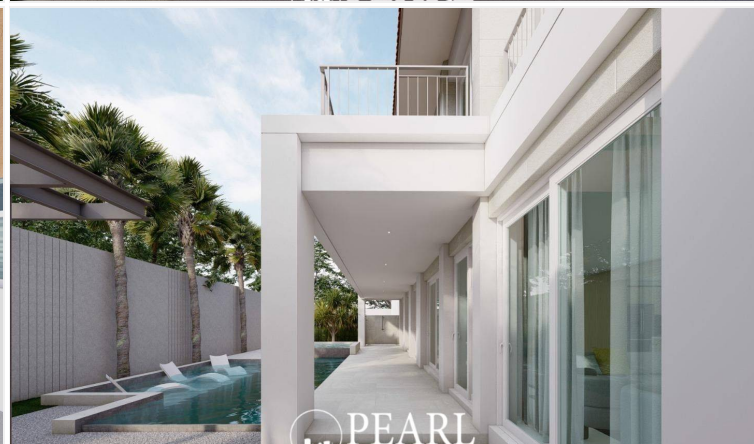
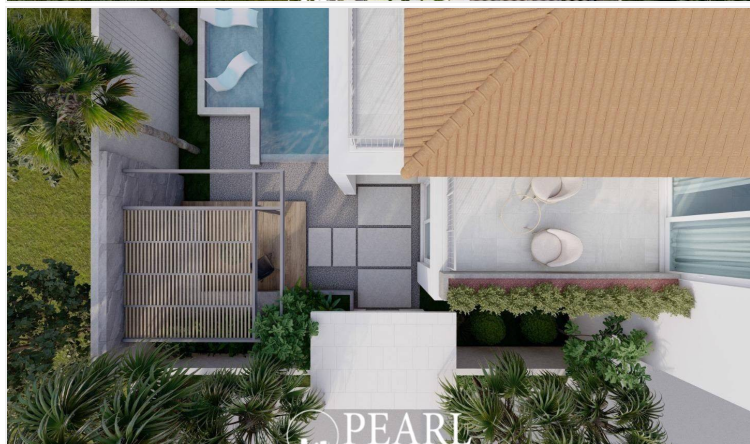
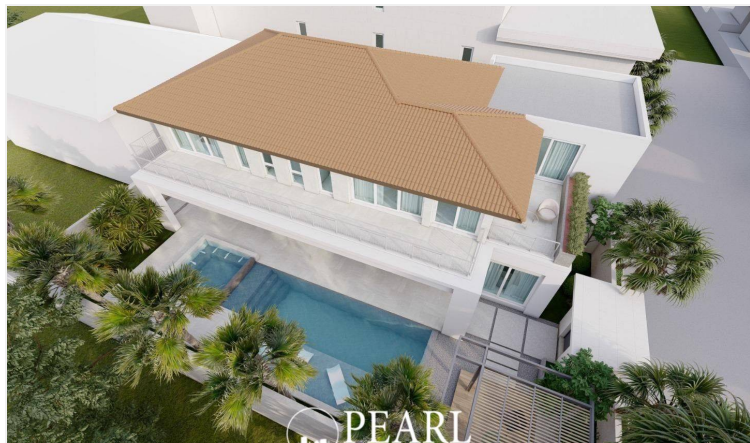

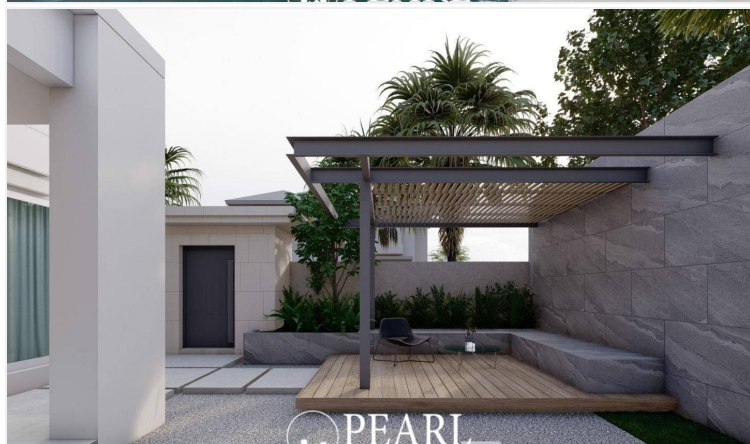
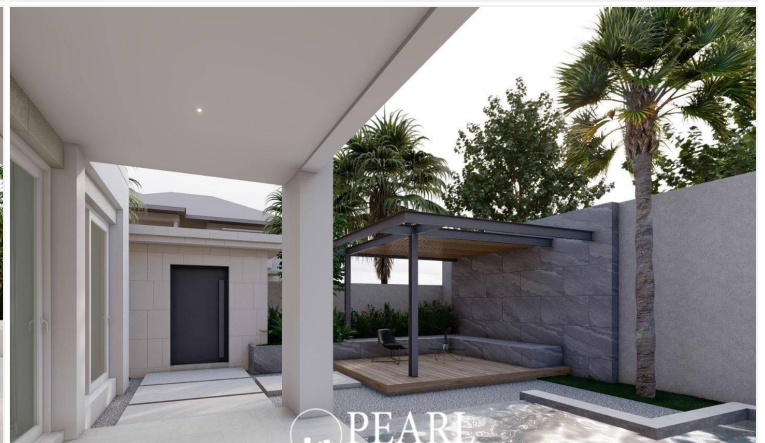
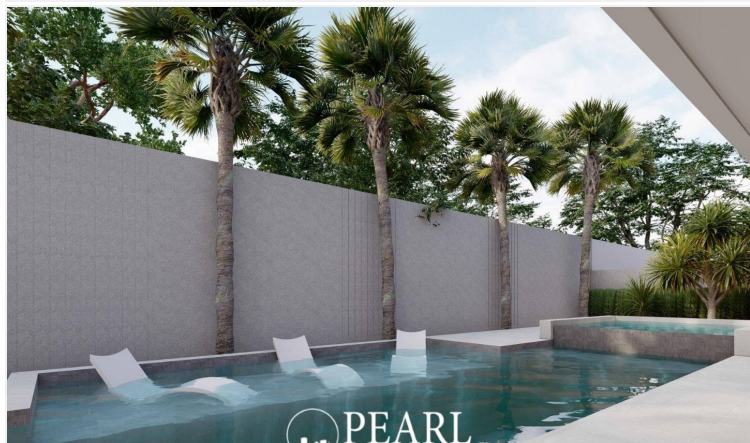
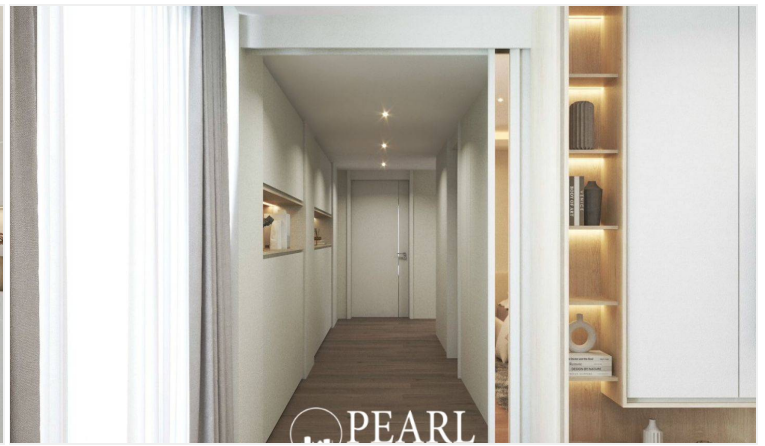
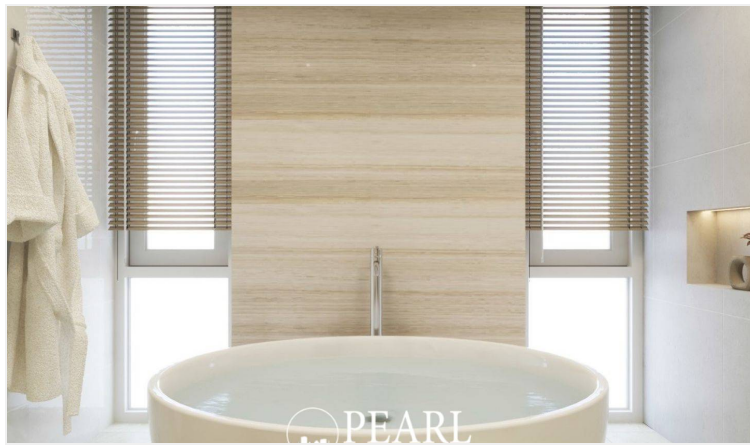

Property Details

- **Property Type:** Villa
- **Location:** Muang Pattaya, Thailand
- **Internal Area:** 682m²
- **Land Area:** 530m²
- **Price:** ~~฿~~**69,000,000**
- **Bedrooms:** 4
- **Bathrooms:** 5

Property Features

- Security
- Gym
- Swimming Pool
- Car Park

Location

